

Optical fiber cable

Indoor Freeform Ribbon™ Cables

Indoor optic fiber cables, ranging from 12 to 1728 fibers. Our lineup covers a wide variety of flame retardancy standards, such as Plenum, Riser, LSZH, and CPR.

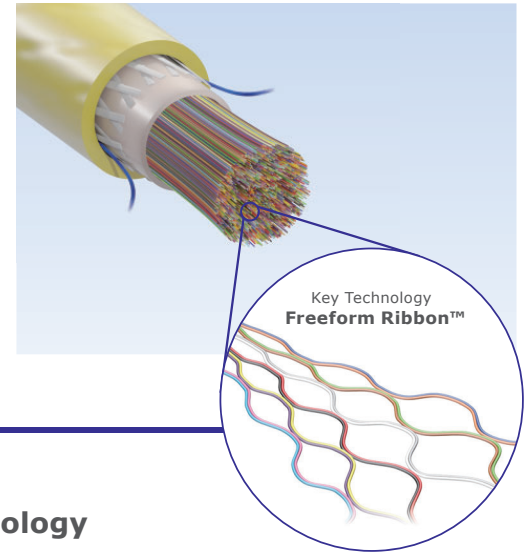

Features

- >> 200µm fiber and 250µm fiber available
- >> High density realized by Freeform Ribbon™ technology
- >> Flame retardant
- >> Steel armoring is applicable

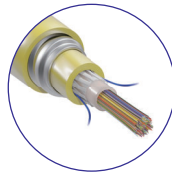

Pliable form

Transforms to suitable position in high density packing

12-fiber Freeform Ribbon™

Conventional 12-fiber Ribbon

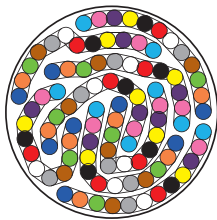

8 Ribbons (96 Fibers)

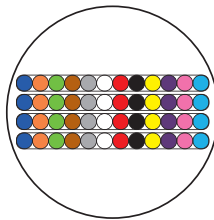

4 Ribbons (48 Fibers)



Easily Split to Single fibers

Connect with single fiber cable easily

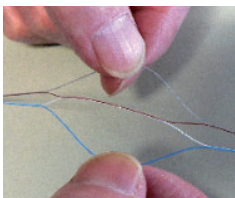

Mass Fusion Splicing

Save fusion splicing time dramatically

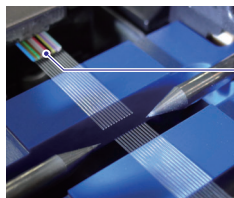

Sumitomo Electric high precision ribbon



- >> Excellent planarity
- >> Even thickness
- >> Constant fiber pitch

[Bad example]



High reliability for splicing

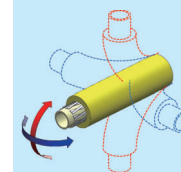

Can be bent in any direction!

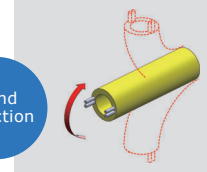

Can be bent only in this direction!



Evaluation for Cable Bending

Bend Insensitive 200μm fiber realize the extreme-density accommodation

Features

- >> Smaller fiber diameter
- >> PureAccess™-PB Bend Insensitive (ITU-T G.652.D / G.657.A1)

Benefits

- >> More fiber count cable
- >> Applicable to narrower duct
- >> Easily work
- >> Reduce installation cost

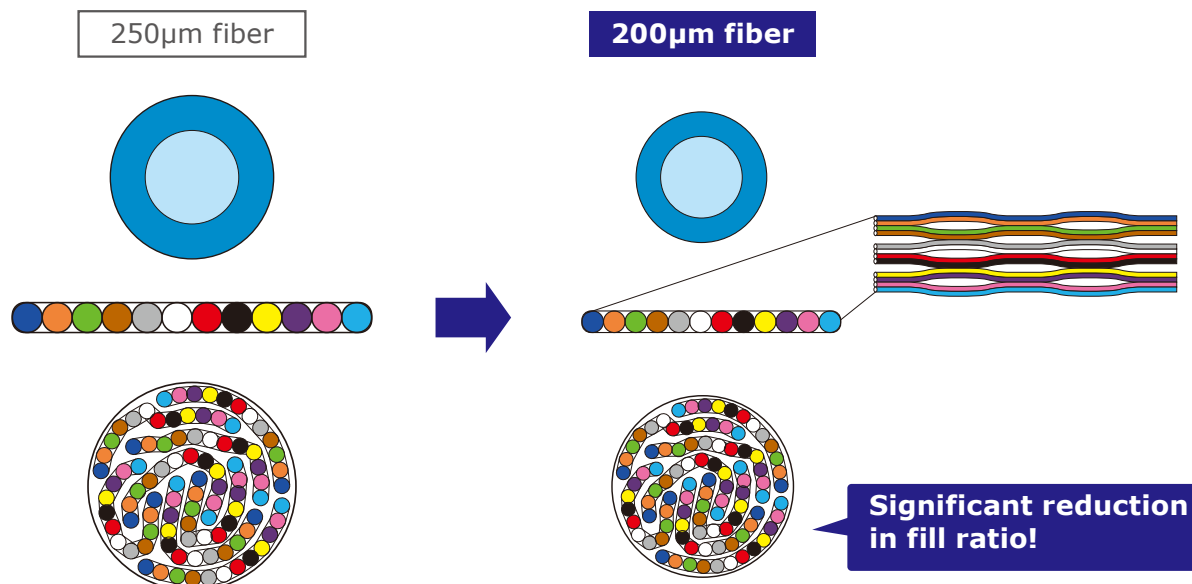

Specification

Plenum grade

Fiber count			48	72	144	288	432	576	864	1152	1728
Optical Fiber Type			PureAccess A1								
250μm	Inside	Dia.(mm)	10.3	11	12	14.4	n/a				
		Weight(kg/km)	131	138	153	200	n/a				
	Cable structure		Central Tube								
	Bend Radius		20xCable OD During Install, 10xCable OD After Install								
	Maximum load(lbs)		300/100								
200μm	Inside	Dia.(mm)	10.3	11	14.4	14.4	n/a				
		Weight(kg/km)	129	134	148	190	n/a				
	Cable structure		Central Tube								
	Bend Radius		20xCable OD During Install, 10xCable OD After Install								
	Maximum load(lbs)		300/100								

Riser grade

Fiber count			48	72	144	288	432	576	864	1152	1728	
Optical Fiber Type			PureAccess A1									
250μm	Inside	Dia.(mm)	n/a			15.7	n/a	21.5	n/a			25.6
		Weight(kg/km)	n/a			297	n/a	334	n/a			475
	Cable structure		Central Tube									
	Bend Radius		20xCable OD During Install, 10xCable OD After Install									
	Maximum load(lbs)		600/200									
200μm	Inside	Dia.(mm)	n/a			14	n/a	21.5	n/a			24.7
		Weight(kg/km)	n/a			171	n/a	313	n/a			389
	Cable structure		Central Tube									
	Bend Radius		20xCable OD During Install, 10xCable OD After Install									
	Maximum load(lbs)		600/200									

Flame retardant type has also been line-up which meets UL 1666 and CSA FT4 specifications.